

# GRID NEWS

LATEST DEVELOPMENTS ON CHICAGO METALLIC™ GRIDS / FEBRUARY 2019

## A TWO FOR ONE – OUR NEW CHICAGO METALLIC™ WALL & BRIDGING BRACKET FOR T PROFILES

Let's make it easy! With just one bracket, improve the way you secure main runners and cross tees to walls and cross tees to walls as well as the way you integrate services.

Our new and easy to use Wall & Bridging bracket (WBBT) for T profiles is a multipurpose accessory that was created with the user in mind and which functions perfectly with our main runners and cross-tees.

It is a two in one tool that enables you to fix our main runners and cross tees to walls or it can be applied to simplify service integration without the hassle and worry of tile deflection.

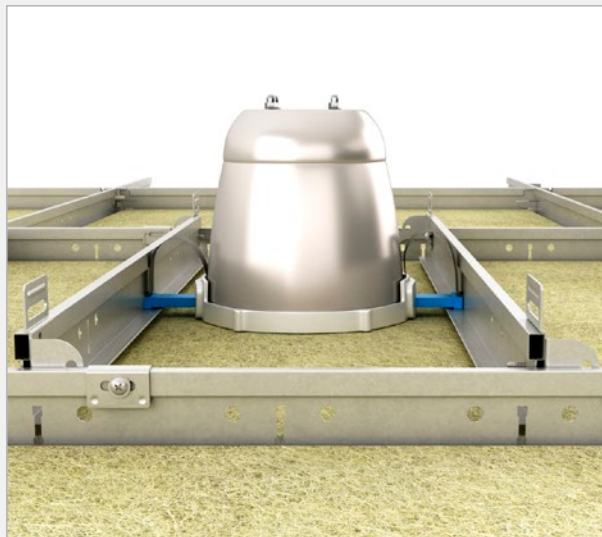

### MAKING CONNECTIONS

The trouble-free WBBT for T profiles enables small adjustments to the position of the grid, making stabilising it to the wall or another T profile much easier than ever before.

[PAGE 2](#)



### BUILDING BRIDGES

Perfectly optimised for our Rockfon Systems, the Bridging bracket feature enables you to secure your T profiles across a variety of tile thicknesses and service dimensions.

[PAGE 4](#)

# MAKING CONNECTIONS

Our Wall & Bridging bracket for T profiles is designed to simplify your installation by offering solutions to different scenarios. It enables small adjustments when securing your bracket to either the wall or a T profile.

## HASSLE-FREE TIME SAVER

The easy to use Wall & Bridging bracket (WBBT) for T profiles allows you to secure and stabilise your main runners and cross tees to the wall or another T profile. Its functionality and design offers a trouble-free installation with its new oblong mounting slot. Replacing the traditional fixing hole, our new design is more flexible when securing the squareness of the grid, it enables small adjustments to the position of the grid. In other words, it eliminates the irritation of marking the wall or your T profile before drilling - saving you time.

## UNOBSTRUCTED FLEXIBILITY

In fact there are two mounting slots; one on the upper and lower side of the bracket, to improve flexibility and increase the simplicity of fastening your T profiles to the wall. This additional mounting slot at the bottom of the bracket allows you to fix your grid to the wall even if there is an obstruction.

This small design feature has a substantial advantage because it means that you won't have to find an ad hoc solution to properly secure your ceiling.



**Oblong mounting slot reduces errors caused by mismeasurement.**



**More fixing possibilities.**



**Enables easy alignment for the squareness of your T grid.**

**Check out our installation video library**

We have recently updated Rockfon System T24 X installation video. Be sure to check it out and subscribe to our YouTube channel for other interesting content.

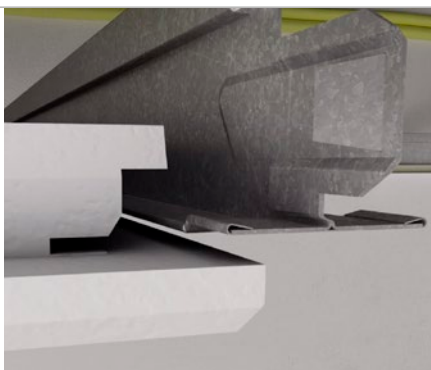

## Performance



**Reaction to fire**  
A1



**Corrosion Resistance**  
B



**Environment**  
Fully recyclable

## HOW TO USE IT

Built for ease of use, another great feature of the WBBT is that it was designed with grooves that indicate the desired height of your T profiles for a variety of edge types when using 24\* x 24 mm or 24\* x 19 mm wall profiles.

Let's have a look at the various installation possibilities.

- 1** To quickly install your Rockfon X-edge or E-edge tile, use your Wall & Bridging bracket for T profiles, positioning your main runner or cross tee against the wall at the appropriate height.
- 2** When installing an X-edge tile, place the lower recess of the bracket on the top of the wall angle. When installing an E edge tile, place the upper recess on the top of the wall angle as shown in the images below.  
\*The WBBT bracket is primarily designed for use with the 24mm dimension of the perimeter wall angle trim fixed to a wall. However, it can be used with other sizes of perimeter wall angle trim and the lower part of the bracket can be easily snapped off to make it universal.



- 3** When installing other ceiling edges using the W-profile, simply rest the bottom of the WBBT bracket for T profiles on the upper flange of the profile.



# BUILDING BRIDGES

The Bridging bracket feature is a straightforward, adjustable and easy solution that is designed perfectly for behind the ceiling service integrations.

## Eliminated deflection

Perfectly optimised for our Rockfon Systems, the Bridging bracket feature provides the means to secure your T profiles across a variety of tile thicknesses ranging anywhere from 0 mm (only relevant for our Chicago Metallic™ T24 Click 2890 or Chicago Metallic T24 Click 2790) to 20 mm.

Easy to install, the bracket is a versatile, non-combustible accessory and can be used for services with different dimensions without the need for using yokes or patresses.

To install the Bridging function of the bracket, simply screw fasten the Wall &



Bridging bracket for T profiles to your main runners and cross tees, transferring the weight of the service to the grid. This ensures that no load rests on the tile, eliminating concerns of deflection.



## How to use it

It is important that the profile is cut straight and that the bracket is snapped along the break line. To properly fasten the brackets to your T profile, simply fix the bracket to the opposite side of your T profile.

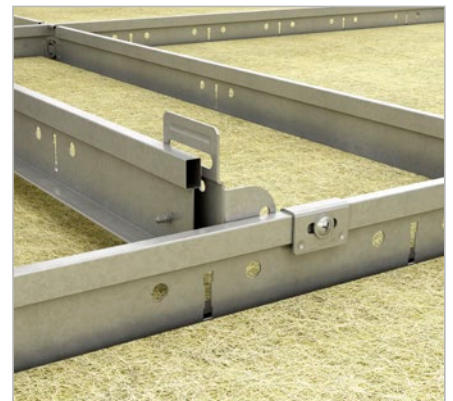

Able to fit many services.



It can be used with all our T-grids.



Create supporting arm for behind the ceiling service integration.